

Assembly and use

Stressless® Mike & Max

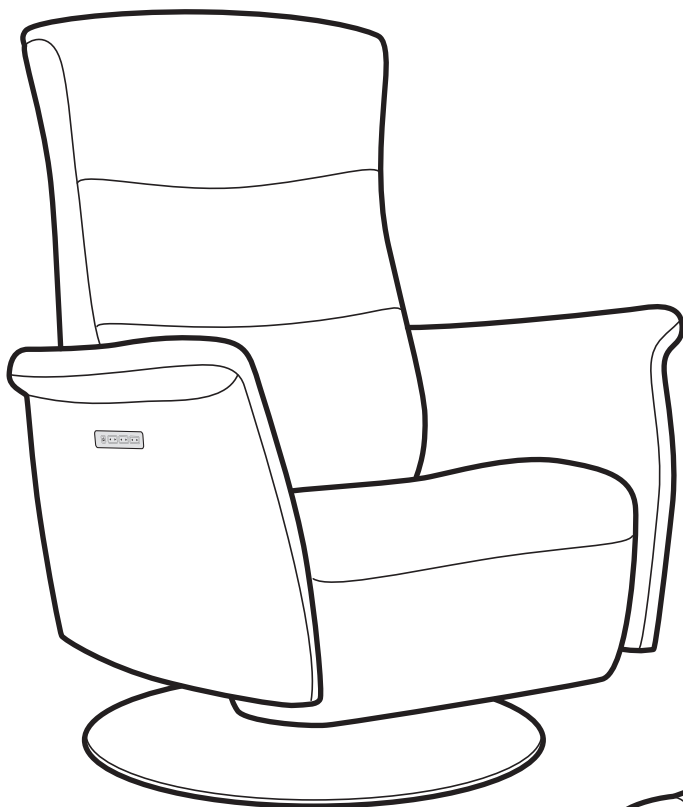

The guide for assembly and use must be carefully read before using the chair.
Keep the guide for future reference!

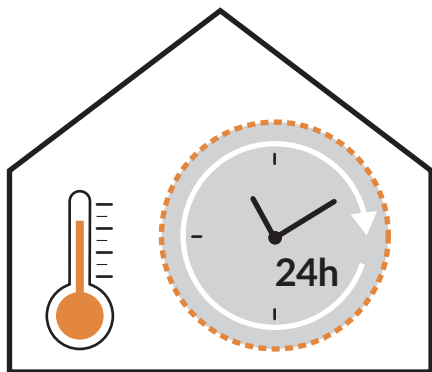

Acclimates indoors for 24
hours before use!

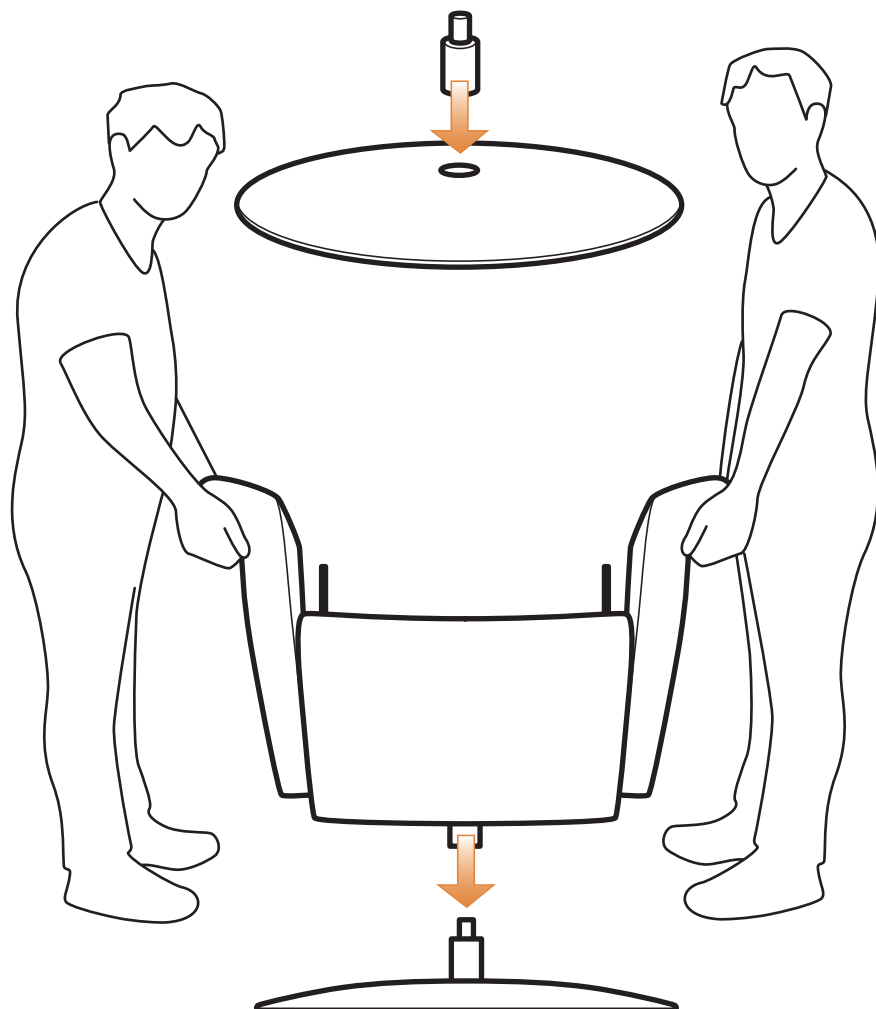
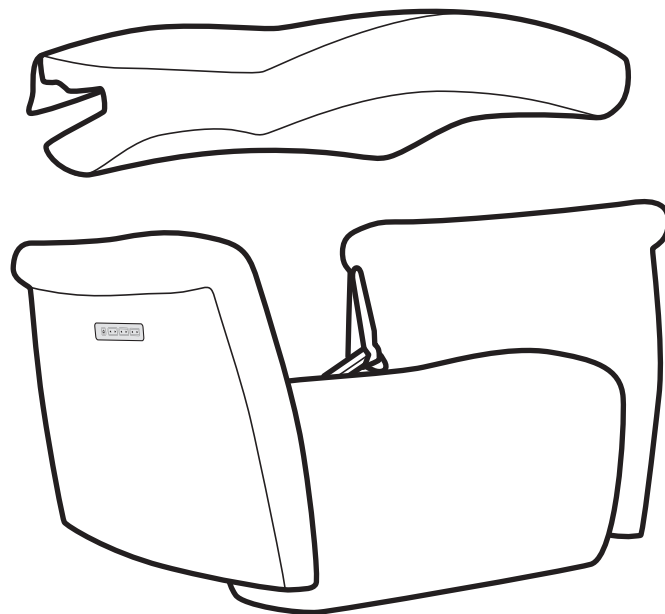



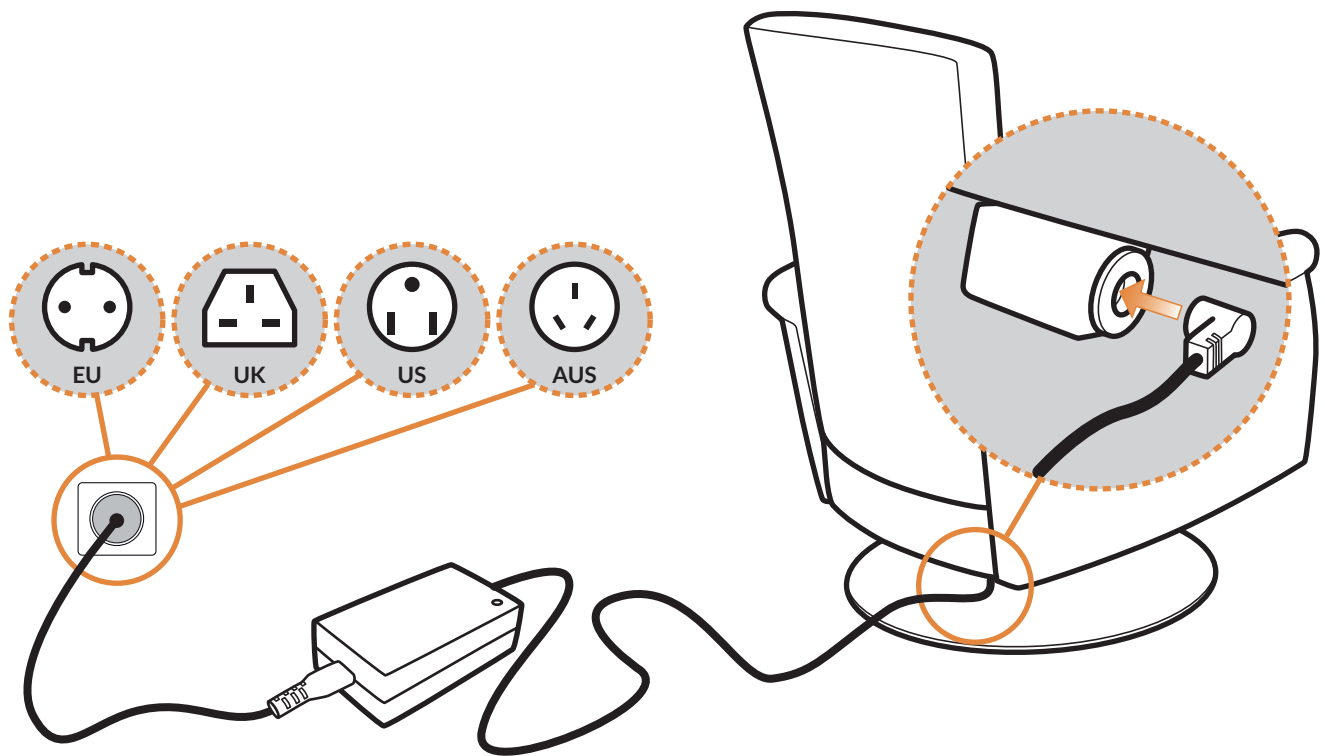

Battery charging

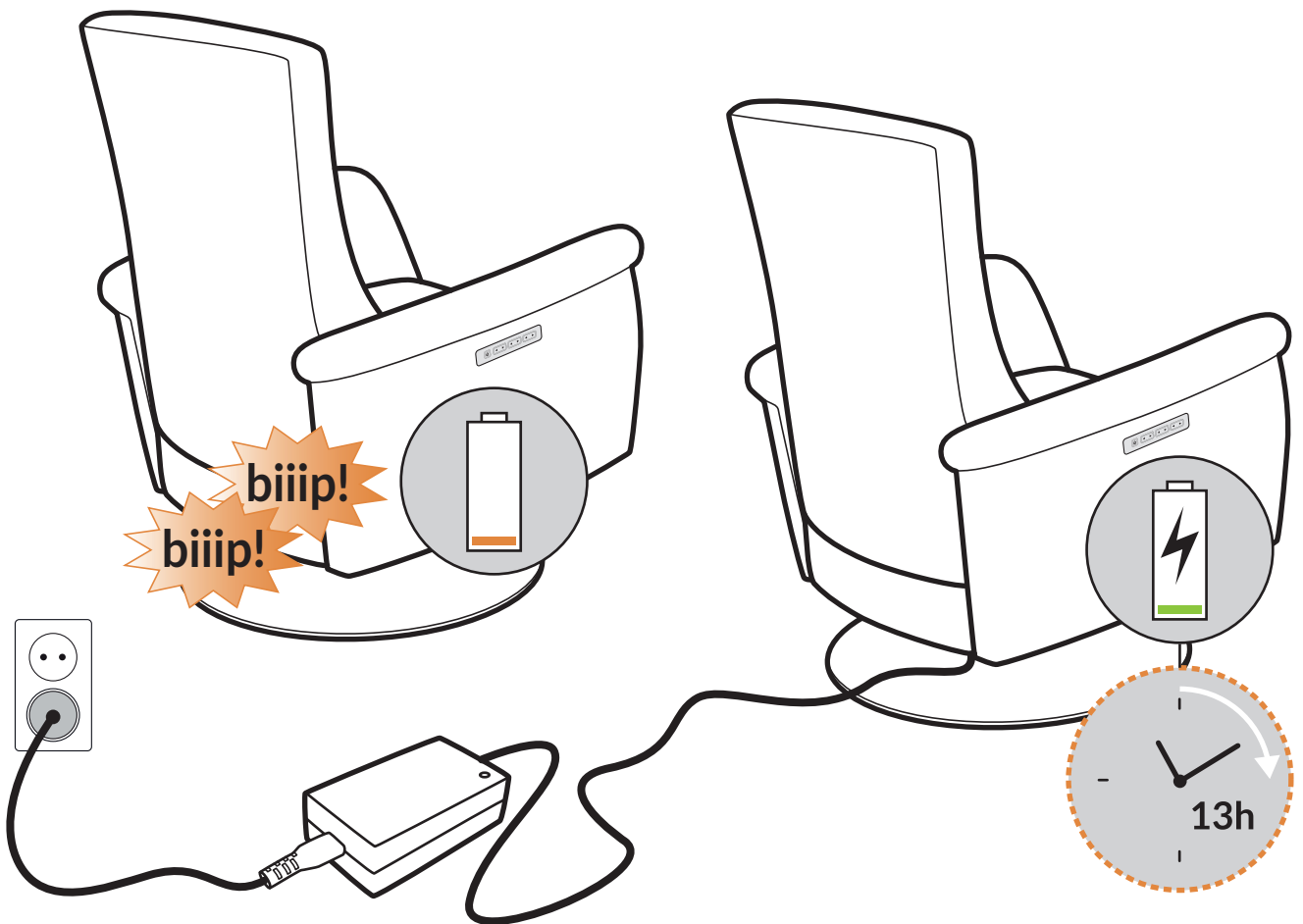

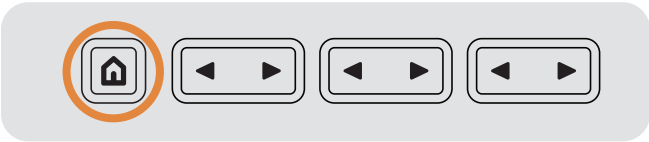
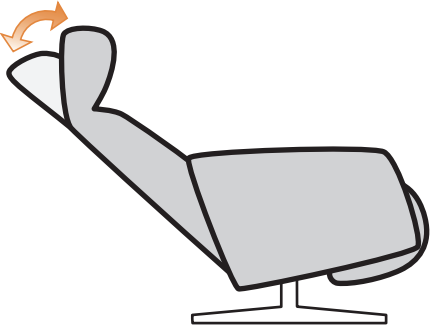
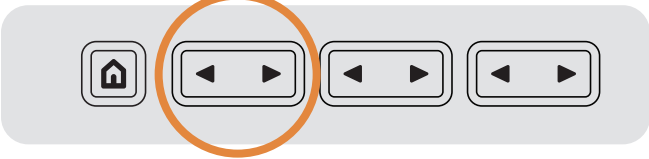
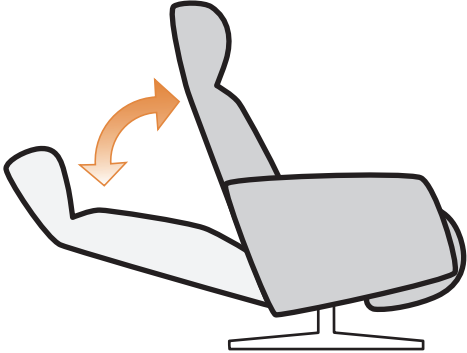
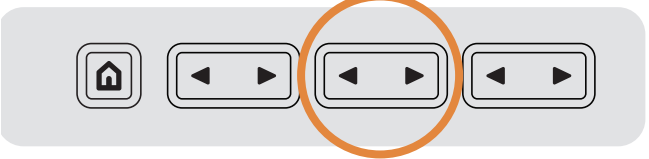
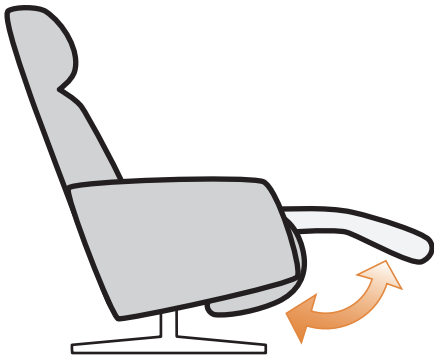
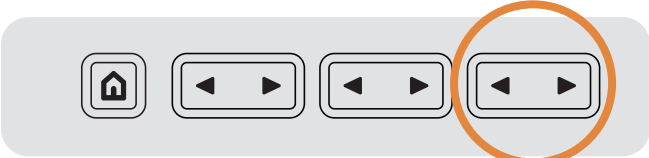
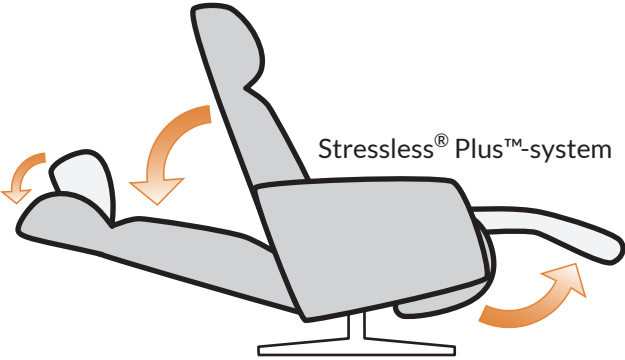
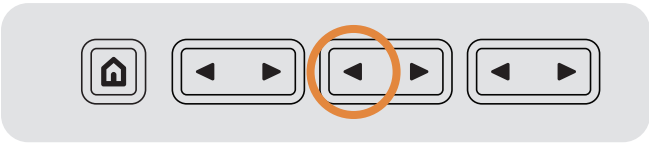

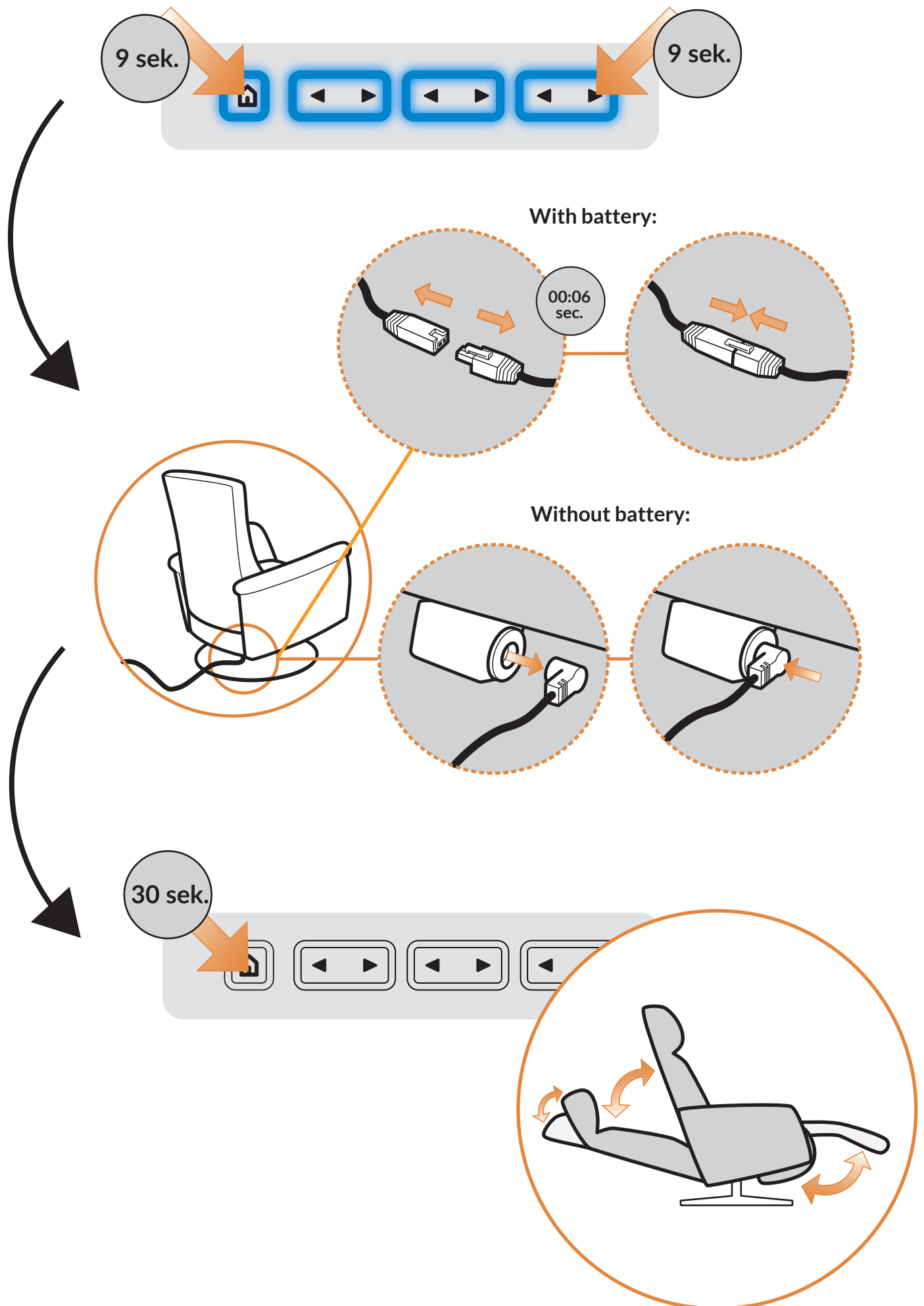

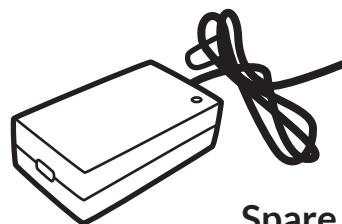
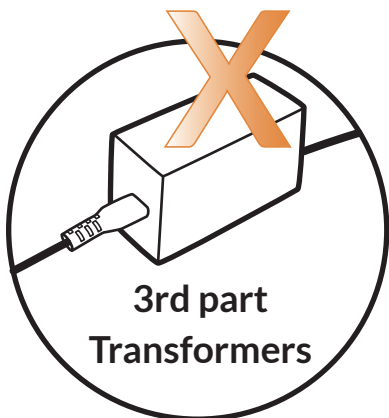

Spare part:
1997433

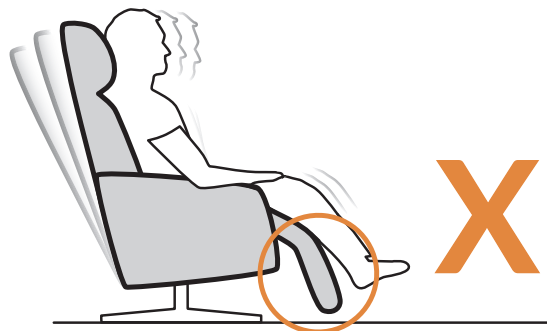
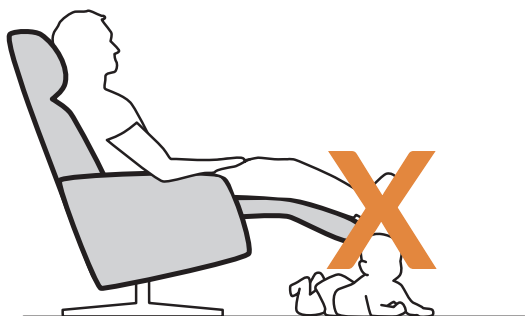

Do not rock the recliner with the leg rest out

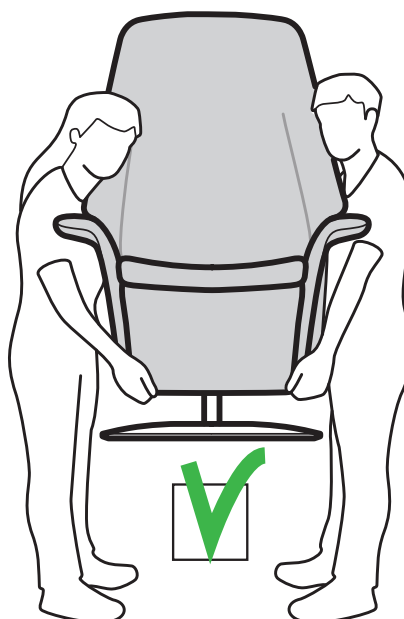
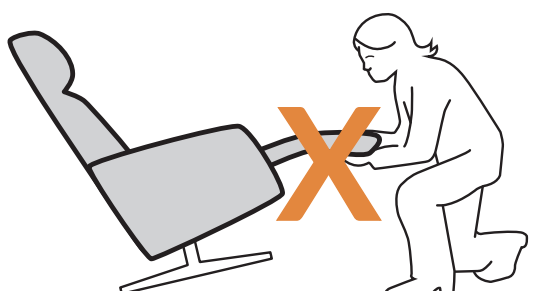
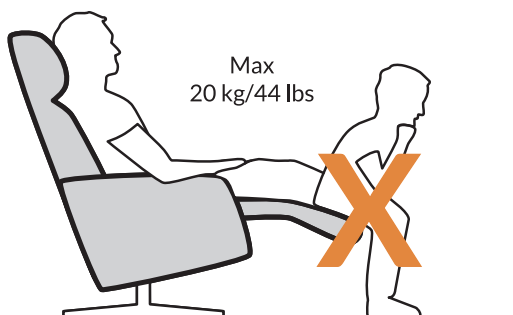
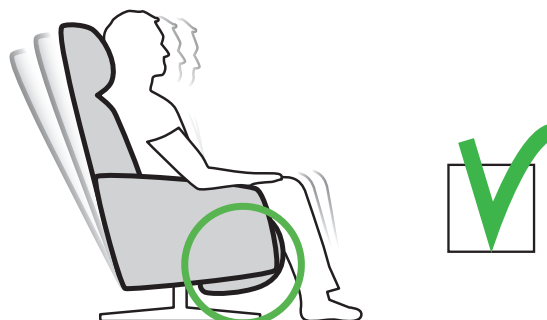
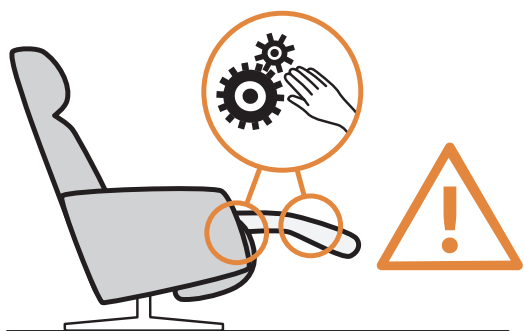



STRESSLESS.COM

Ekornes AS, Industrivegen 1, N-6222 Ikkornes
Tel.: (+47) 70 25 52 00
E-mail: office.no@ekornes.com